

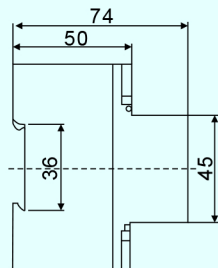

◆ Overall and installation dimensions

Weight: about 0.9kg

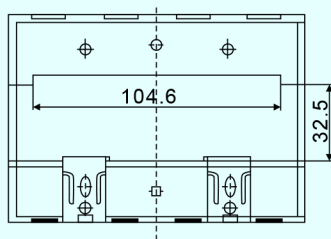
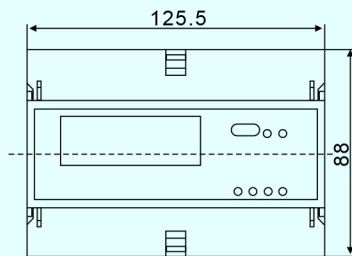

◆ Product Overview

The three-phase multi-rate watt-hour meter track can be accurately measured active positive and negative direction, with the meritorious record of aximum demand function, voltage, current, power and other electrical parameters in real-time measurement and processing, with time-sharing control, automatic meter reading, the amount of electricity and the need for data storage, energy meter records of the current operational status, event data recorders and other functions, to achieve energy hourly metering and accounting work in an ideal intelligent instrument. Watt-hour meter using a large-screen LCD display, with far-infrared, RS485 communication interface etc. The instrument for the introduction of advanced ultra-low power consumption LSI technology and SMT process manufacturing high-tech products, Selection of the key components of internationally famous brands of long-life devices, with good reliability, small size, light weight, beautiful appearance, easy installation etc.

This product complies with IEC62053-21 standard requirements for active power meter, GB / T 15284-2002 special requirements for multi-rate watt-hour meter, JJG596-1999 Electronic Energy Meter Verification Regulation, DL / T 614-1997 Multi-function watt-hour meter, DL / T 645-1997 Multi-function watt-hour meter communication protocol, "Zhejiang Province, three-phase electronic type (hourly) energy meter technical conditions (for trial implementation)" "Zhejiang Province, three-phase electronic type (TOU) power meter communication protocol conditions (for trial implementation)" (V3.0).

◆ Features

- 4 kinds of rates (sharp, peak, flat, valley), 12 hours, times the minimum time interval of 5 minutes;
- Storage, including this month, including a 12-month data on the various rates for electricity;
- Electrical isolation using advanced energy metering chip, high-performance CPU and the RTC clock chip;
- Records of the current total active power consumption and the rate of electricity consumption and save the data;
- High-precision, high reliability, strong overload capacity, low power consumption, light weight;
- Automatic cumulative record of the battery working hours;
- Round of significant current time, rate, total electricity consumption and the rate of electricity consumption;
- Communication protocol in line with DL / T 645-1997;
- With pulse output, pulse width $80\text{ms} \pm 20\text{ms}$;
- Can set the table number, bureau number, hours, rates, date, time, automatic meter reading date, password, display items and start recycling capacity;
- Can jog round the table covered with remarkable power button to view the user selected parameters;
- With maximum measurement functions required.
- When the meter communicating with external devices, communication indicator light, said the state energy meter in communication.

◆ The main technical parameters

Rated Current	3×1.5(6)A, 3×5(20)A, 3×10(60)A, 3×15(60)A, 3×20(80)A, 3×30(100)A
Rated voltage	three-phase four-wire 3 × 220/380V, or 3 × 57.7/100V 3 × 100V three-phase three-wire or 3 × 380V
Rated frequency	50Hz, 60Hz
Accuracy Class	Class 1.0, Class 2.0
Clock error	≤ 0.5 sec / day (reference temperature); ≤ 1.0 sec / day (back-up lithium battery work)
Battery	lithium battery imports of environmental protection, voltage: 3.0 or 3.6V, capacity ≥ 1000mAh
Communication	RS485